

Einlegemutter, Federmutter
 Insertion nut, spring nut
 Écrou de pose, écrou à ressort
 Dado di posa, dado a molla
 Tuerca de insercion, tuerca de resorte

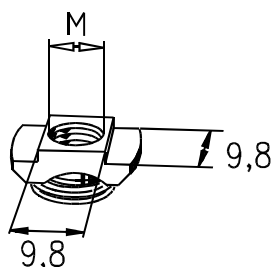
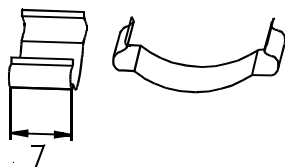
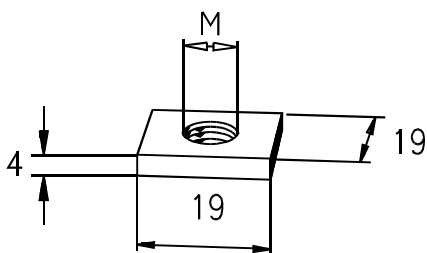
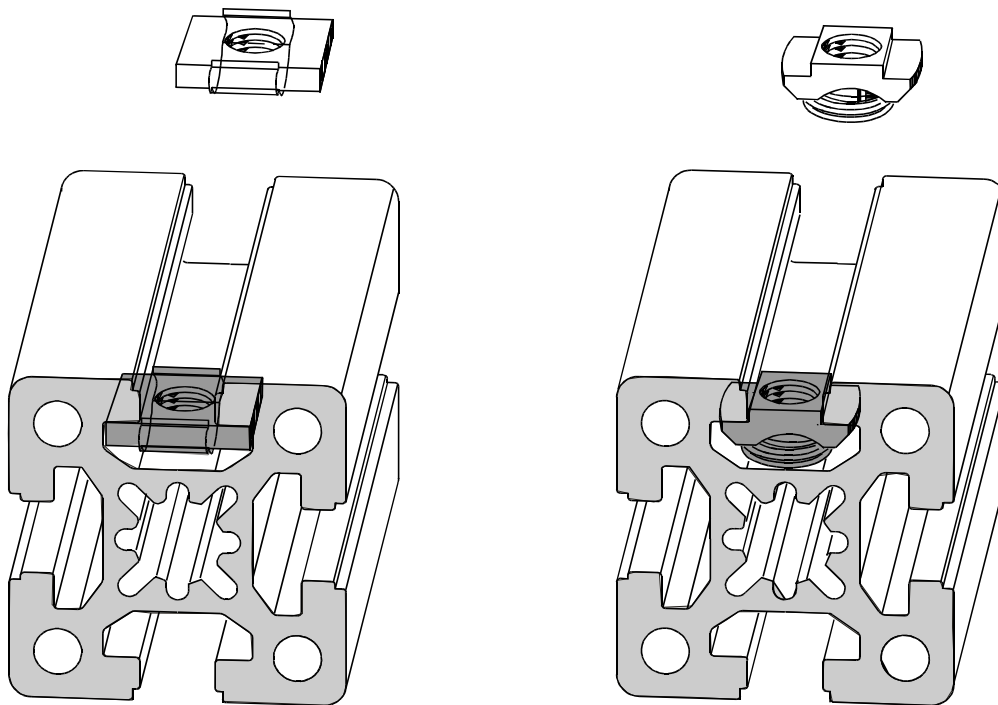

| | | |
|---------------------|----|------|
| Einlegemutter | M4 | 1124 |
| Insertion nut | M5 | 1125 |
| Écrou de pose | M6 | 1126 |
| Dado di posa | M8 | 1127 |
| Tuerca de insercion | | |
| Fixierfeder | | 1617 |
| Spring | | |
| Ressort | | |
| Molla | | |
| Resorte | | |
| Federmutter | M4 | 1606 |
| Spring nut | M5 | 1607 |
| Écrou a ressort | M6 | 1608 |
| Dado a molla | M8 | 1609 |
| Tuerca de resorte | | |

Stahl verzinkt * galvanized steel * acier zingué
 acciaio zincato * acero cincado

Einschwenkmutter
 T-nut, drop-in type
 Écrou orientable
 Dado orientabile
 Tuerca giratoria

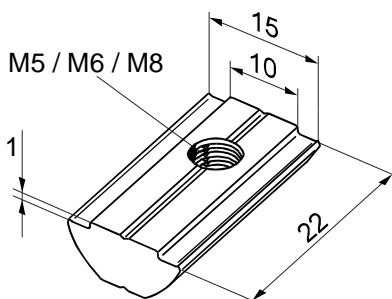
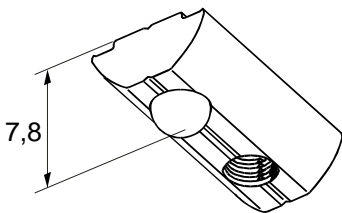
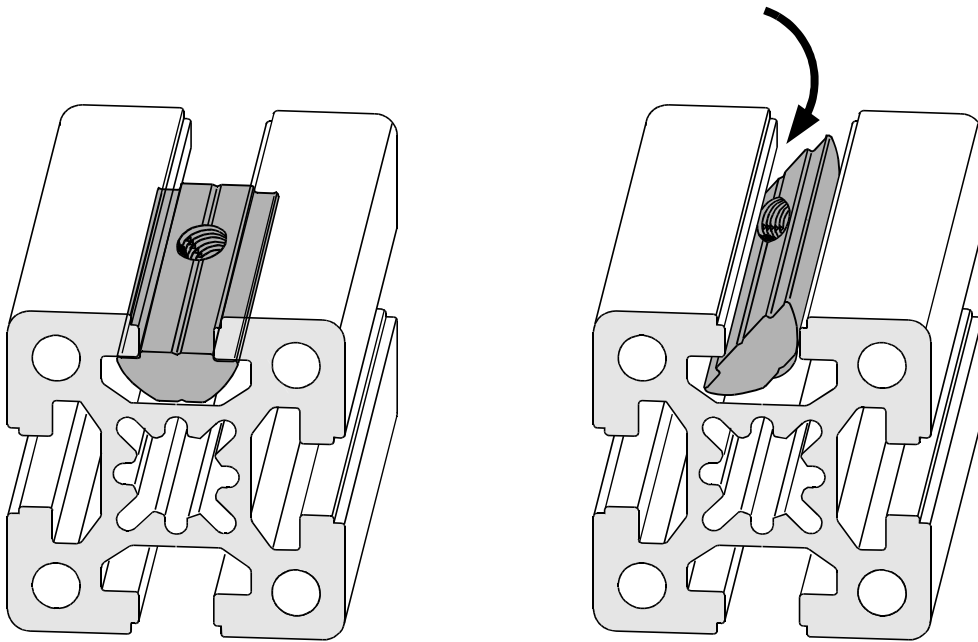

Einschwenkmutter M5
 T-nut, drop-in type M6
 Écrou orientable M8
 Dado orientabile
 Tuerca giratoria

1614

1615

1616

Stahl verzinkt * galvanized steel * acier zingué
 acciaio zincato * acero cincado